



**545 - 2010**

<https://www.yachtadvert.com/fr/1056-hanse-545.html>

**259 500 EUR ttc**



## Général

Constructeur : Hanse  
Matériau : GRP Poly  
Largeur : 4,88 m  
Quille : Quille ailette  
Région : Preveza, Greece, Grèce

Sous type : Plaisance  
Année : 2010  
Longueur : 16,46 m  
Tirant d'eau : 0,00 m  
Radeau : Non  
Leasing en cours : Non

## Moteurs

Carburant : Diesel  
Puiss. Unit. (CV) : 82

Marque moteur : Yanmar  
Nombre : 1

# Aménagements

Flybridge : Non

Timonerie : Non

---

## électronique

Pilote auto : Non

GPS : Non

VHF : Non

Déssalinisateur : Non

Radar : Non

Sondeur : Non

Traceur de carte : Non

Convertisseur 12/220 : Non

---

## équipement de pont

Hydraulique : Non

Plateforme AR : Non

Taud d'hivernage : Non

Capote de roof : Non

Cockpit en teck : Non

Grand voile sur enrouleur : Non

Passerelle : Non

Bossoirs : Non

Guindeau électrique : Non

Taud cockpit : Non

Pont teck : Non

Génois sur enrouleur : Non

Spinnaker : Non

---

## équipements principaux

Propulseur Arrière : Non

Clim. : Non

Eaux noires : Non

Annexe : Non

Propulseur avant : Non

Groupe élec. : Non

Eau chaude : Non

Flaps : Non

Moteur annexe : Non

---

# électroménager

Congélateur : Non  
Micro-ondes : Non  
Réchaud électrique : Non  
Lave-linge : Non  
Antenne TV : Non  
TV SAT : Non

Glaçons : Non  
Four : Non  
Réchaud gaz : Non  
Chauffage : Non  
Lave-vaisselle : Non  
TV : Non

---

## Divers

**Remarks :**

**Hanse 545 (2010) &ndash; EU VAT Paid | Lightly Used | Lying Greece</strong></p><p>Delivered new in 2010 and privately owned since 2015, this is an exceptionally well-kept example of the popular <strong>Hanse 545</strong>, designed by Judel/Vrolijk and built in Germany. Originally used as a factory demonstrator, she has since been cruised lightly and maintained to a high standard by a single private family ownership.</p><p>She offers the perfect balance of <strong>performance, comfort, and simplicity</strong>, with the Hanse Easy Sailing system &mdash; <strong>self-tacking jib</strong>, <strong>in-mast furling</strong>, and <strong>electric winches</strong> &mdash; making her easily handled by a couple. Below, the interior is bright, modern, and well laid out for extended living aboard, with <strong>three generous cabins</strong>, two heads with <strong>separate stall showers</strong>, a long galley, and excellent ventilation throughout.</p><p>Low engine and generator hours, <strong>VAT paid status</strong>, and a recent round of smart upgrades &mdash; including a <strong>new watermaker</strong> and <strong>radar system</strong> (Winter 2024/25) &mdash; complete the package.</p><div align="center"><hr align="center" size="2" width="100%"></div><p><strong>Highlights</strong></p><ul><li>Yanmar 110 hp engine &ndash; only <strong>1,031 hours</strong></li><li>Fischer Panda generator &ndash; approx. <strong>400 hours</strong></li><li><strong>EU VAT paid</strong> &ndash; privately owned and well documented</li><li><strong>New watermaker</strong> and <strong>new radar</strong> (Winter 2024/25)</li><li>North Sails (2016) in excellent condition</li><li><strong>In-mast furling</strong> mainsail and <strong>self-tacking jib</strong></li><li>3 electric winches &ndash; Easy Sailing setup</li><li><strong>Air conditioning</strong> (3 x Clima Vega Mk3 units)</li><li>3 double cabins / 2 heads with <strong>separate shower stalls</strong></li><li>Teak deck in excellent condition</li><li>Drop-down transom with <strong>tender garage</strong></li><li>Sail locker forward, convertible to skipper cabin</li><li>LG washer-dryer fitted</li></ul><p>&nbsp;</p><p><strong>Why She Stands Out</strong></p><p>Few examples of the Hanse 545 come to market with such light use and thoughtful upgrades already in place. The combination of <strong>low maintenance hours</strong>, a <strong>cruising-friendly layout</strong>, and equipment like <strong>air conditioning</strong>, a <strong>tender garage</strong>, and a <strong>washer-dryer</strong> make her ideal for extended Mediterranean seasons or offshore passages.</p><p>With her clean lines, flush deck, and German build quality, she offers both sailing pleasure and excellent onboard comfort.</p><p><strong>&nbsp;</strong></p><p><strong>Broker&rsquo;s Remarks</strong></p><p>A very well-maintained and sensibly upgraded Hanse 545 with <strong>EU VAT paid</strong>, low hours, and key systems already renewed. Well suited to sailors looking for a stylish, capable cruiser with the features needed for independent Mediterranean cruising.</p>**

**Accommodation :**

**ACCOMMODATION**

- 3 cabins, 2 heads (both with separate shower stalls)
- Forward owner&rsquo;s cabin with island berth
- Ensuite heads with stall shower
- Two aft cabins (starboard double, port Pullman)
- Aft heads with stall shower
- Bright saloon with L-sofa

- &bull; Lounge seating to starboard
- &bull; Galley to starboard
- &bull; Nav station to port
- &bull; Mahogany joinery
- &bull; LED lighting
- &bull; Ivory upholstery
- &bull; Cabin and saloon fans

**LAYOUT**

Owner's cabin forward with ensuite. Saloon amidships, galley to starboard, nav station to port. Two aft cabins and aft heads with shower. Forward sail locker accessible from deck.

**DOMESTIC**

- &bull; Corian worktop with split sinks
- &bull; 130L top/front-opening fridge
- &bull; Gimballed gas cooker
- &bull; Air conditioning (3 units &ndash; Clima Vega Mk3)
- &bull; Jabsco toilets
- &bull; LG Direct Drive 5 kg / 2.5 kg washer-dryer
- &bull; Cockpit cushions
- &bull; Sprayhood (Masacril dark grey)
- &bull; Bimini (Masacril dark grey)

**TENDER**

- &bull; Sea covers and wheel covers
- &bull; Tender garage (no tender included)

**MISCELLANEOUS**

- &bull; Removable inner forestay
- &bull; Spinnaker pole
- &bull; Full manuals onboard
- &bull; Winter upgrade programme
- &bull; EU VAT PAID

**Inventory :**

**SAFETY**

- &bull; Manual and electric bilge pumps
- &bull; Fire extinguishers
- &bull; Jackstays
- &bull; Emergency tiller
- &bull; Navigation and anchor lights
- &bull; Life raft (service status to be checked)

**EXTRA DETAILS**

- &bull; One private owner
- &bull; Ex-Hanse show yacht
- &bull; Light Mediterranean cruising
- &bull; Strong maintenance history

**TITLE DOCUMENTS AND TAX**

Listed below are the documents we have reviewed:

- &bull; Builder's Certificate
- &bull; RCD Certificate of Conformity
- &bull; UK Part I Registration Certificate (expired)
- &bull; EU VAT Invoice (German dealer to owner)
- &bull; Bill of Sale &ndash; Hanse to owner
- &bull; Full equipment manuals onboard

**VAT STATUS: EU VAT PAID**

**KNOWN DEFECTS**

None

**HISTORY**

Built in 2010, used as a Hanse factory show yacht, then sold to current owners in 2015. Lightly cruised in the Mediterranean with professional maintenance. Winter upgrade programme underway.

**Mechanical :**

**CONSTRUCTION**

Sloop rigged with a removable inner forestay

Engine Number: E123894

HIN: DE-HANS0209B010

VAT STATUS: EU VAT PAID

- &bull; Vacuum-bagged pre-preg E-glass with epoxy
- &bull; Corecell foam-cored topsides
- &bull; GRP structural grid bonded to hull
- &bull; GRP ring frames tabbed to hull and deck
- &bull; Deck: balsa-core GRP with teak overlay
- &bull; Vinylester osmosis-resistant outer skin
- &bull; Hull-deck shoebox joint bonded and mechanically fastened
- &bull; Flush deck hatches and coachroof windows</p><p><strong>DIMENSIONS</strong>
- &bull; LOA: 16.20 m (53 ft 2 in)
- &bull; LWL: 14.60 m (47 ft 11 in)
- &bull; Beam: 4.91 m (16 ft 1 in)
- &bull; Draft: 2.43 m (7 ft 11 in)
- &bull; Displacement: approx. 20,200 kg
- &bull; Ballast: approx. 5,808 kg</p><p><strong>MECHANICAL</strong>
- &bull; Yanmar 4JH4-HTE1 diesel (110 hp)
- &bull; Engine hours: 1,031
- &bull; Engine Number: E123894
- &bull; Shaft drive, 3-blade bronze propeller
- &bull; Fischer Panda generator approx. 400 hours
- &bull; Retractable bow thruster
- &bull; Hot/cold pressurised water
- &bull; Winter 2024/25 upgrades: new watermaker and radar</p><p><strong>PERFORMANCE</strong>
- &bull; Judel/Vrolijk performance hull
- &bull; Excellent for single/short-handed use
- &bull; In-mast furling mainsail
- &bull; Self-tacking jib
- &bull; Removable inner forestay
- &bull; Spinnaker pole</p><p><strong>TANKAGE</strong>
- &bull; Fuel approx. 375 litres
- &bull; Water approx. 690 litres
- &bull; Holding tanks fitted</p><p><strong>ELECTRICAL</strong>
- &bull; Domestic battery bank: 4 &times; 165 Ah
- &bull; Shore power
- &bull; Battery charger and inverter
- &bull; Fischer Panda generator approx. 400 hours
- &bull; LED lighting
- &bull; 230V sockets
- &bull; 12V outlets
- &bull; Electrical panels at nav station</p><p><strong>RIGGING</strong>
- &bull; Aluminium 3-spreader mast
- &bull; Sloop rigged with a removable inner forestay
- &bull; In-mast furling
- &bull; Self-tacking jib track
- &bull; Furlex 400 genoa furler
- &bull; Removable inner forestay
- &bull; Spinnaker pole
- &bull; Rod kicker
- &bull; Stainless steel standing rigging (original)
- &bull; All running rigging led aft</p><p><strong>SAILS</strong>
- &bull; Mainsail &ndash; in-mast furling (North Sails 2016, excellent)
- &bull; Self-tacking jib (North Sails 2016, excellent)
- &bull; Furling genoa (Furlex 400)
- &bull; Additional sails in forward locker</p><p><strong>NAVIGATION</strong>

- &bull; B&G chartplotter (nav station)
- &bull; B&G/Simrad chartplotter (helm)
- &bull; Simrad AP24 autopilot
- &bull; Simrad IS20 wind/speed/depth
- &bull; AIS transceiver
- &bull; Lewmar AA560 chain counter
- &bull; Compass
- &bull; Radar upgrade planned Winter 2024/25
- &bull; Navigation lights<p><strong>DECK</strong>
- &bull; Full teak deck, excellent
- &bull; Twin helm stations with seating
- &bull; Lewmar 54 electric primary winches
- &bull; Lewmar 54 electric coachroof winch
- &bull; Lofrans Project 1000 electric windlass
- &bull; Electric capstan on foredeck
- &bull; Cockpit table
- &bull; Cockpit cushions
- &bull; Forward sail locker (convertible)
- &bull; Fold-down transom swim platform with tender garage
- &bull; Hot/cold deck shower
- &bull; Stainless swim ladder<p></strong>





## HANSE 545 3 Cabin version

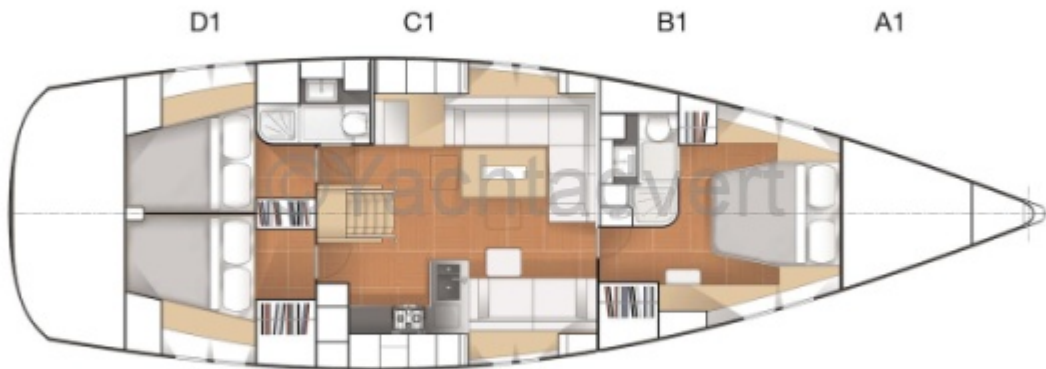

## HANSE 545 3 Cabin version

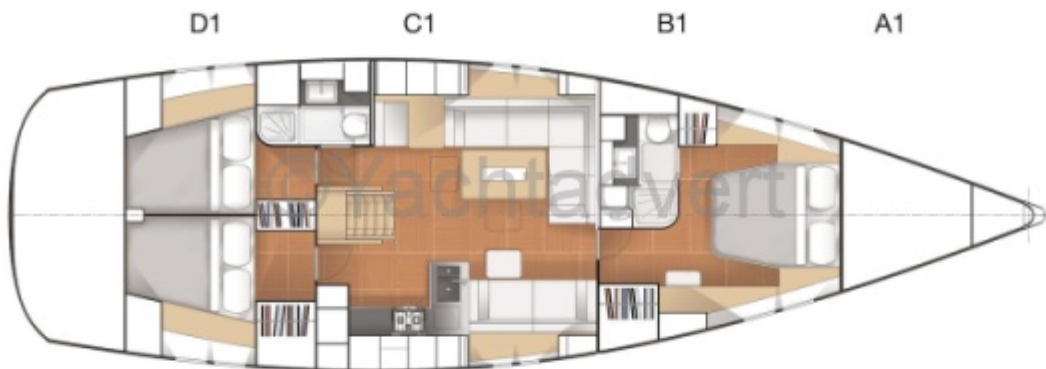

## HANSE 545 3 Cabin version

