



38 Ocean - 1999

<https://www.yachtadvert.com/fr/2100-bavaria-38-ocean.html>

65 000 EUR ttc



Général

Constructeur : Bavaria
Matériau : GRP Poly
Largeur : 3,96 m
Radeau : Non
Leasing en cours : Non

Sous type : Plaisance
Année : 1999
Longueur : 11,28 m
Tirant d'eau : 0,00 m
Région : Preveza, Grèce

Moteurs

Carburant : Diesel
Puiss. Unit. (CV) : 50

Marque moteur : Volvo MD22L
Nombre : 1

Aménagements

Flybridge : Non

Timonerie : Non

électronique

Pilote auto : Non

GPS : Non

VHF : Non

Déssalinisateur : Non

Radar : Non

Sondeur : Non

Traceur de carte : Non

Convertisseur 12/220 : Non

équipement de pont

Hydraulique : Non

Plateforme AR : Non

Taud d'hivernage : Non

Capote de roof : Non

Cockpit en teck : Non

Grand voile sur enrouleur : Non

Passerelle : Non

Bossoirs : Non

Guindeau électrique : Non

Taud cockpit : Non

Pont teck : Non

Génois sur enrouleur : Non

Spinnaker : Non

équipements principaux

Propulseur Arrière : Non

Clim. : Non

Eaux noires : Non

Annexe : Non

Propulseur avant : Non

Groupe élec. : Non

Eau chaude : Non

Flaps : Non

Moteur annexe : Non

électroménager

Congélateur : Non
Micro-ondes : Non
Réchaud électrique : Non
Lave-linge : Non
Antenne TV : Non
TV SAT : Non

Glaçons : Non
Four : Non
Réchaud gaz : Non
Chauffage : Non
Lave-vaisselle : Non
TV : Non

Divers

Remarks :

Bavaria 38 Ocean Centre Cockpit yacht, well-suited to comfortable long-distance cruising. She has benefitted from conscientious private ownership and regular maintenance, including recent upgrades to batteries and canvas. Designed by J&J Design and built in Germany, she delivers reliable performance, a solid build, and a practical layout. Her spacious teak-decked cockpit, in-mast furling, and wide beam make her ideal for effortless island hopping with family or friends.

Highlights Listed below but included in Full Specs:

- Bavaria 38 Ocean Centre Cockpit, 1999
- Stainless Solar Arch 4 solar panels
- Coppercoated
- Folding Propeller
- In-mast furling with good sail inventory
- 2 double cabins + 2 saloon singles
- New batteries (2025)
- Raymarine chartplotter (2021)
- Sprayhood (new), cockpit cushions, and teak decks

• EU VAT Paid -Greek Unlimited Transit Log

Accommodation :

• **ACCOMMODATION**

• Cabins: 2 double cabins + saloon with 2 singles

- Berths: 6
- Headroom: Approx. 6 ft
- Upholstery: Fabric
- Heating: Eberspacher forced air
- Heads: 1 manual
- Shower: 1 plus deck shower
- Hot Water: Yes – calorifier/immersion

• Galley: Pressurised water, gas hob, oven, galley sink, fridge

LAYOUT

Centre cockpit layout with spacious aft double cabin and forward guest cabin, both offering good privacy. Saloon converts to additional sleeping if needed, with generous seating and a practical L-shaped galley to port.

DOMESTIC

Plenty of storage throughout.

Disclaimer

The Company offers the details of this vessel in good faith but cannot guarantee or warrant the accuracy of this information nor warrant the condition of the vessel. A buyer should instruct his agents, or his surveyors, to investigate such details as the buyer desires validated. This vessel is offered subject to prior sale, price change, or withdrawal without notice.

Inventory :

- **NAVIGATION**
- Chart Plotter: Raymarine (2021)
- Wind Instrument: Raytheon (requires replacement)

- GPS: Raytheon RL70
- AIS: Not connected
- Autopilot: Autohelm ST6000
- Navtex: Nassa Navtex Pro
- Compass: Yes
- VHF: Raytheon
- Log/Speed: Raytheon (requires replacement)
- Decking: Teak
- Anchor: Bower Spade + Kedge Fortress
- Chain: 80m, 8mm galvanised
- Windlass: Lofrans 1000W
- Winches: 2 x Harken 44, 2 x Harken 40
- Cockpit Shower: Yes (hot & cold)
- Cockpit Table: Folding
- Boarding Ladder
- Liferaft: 4-man (requires servicing)
- 2 x Auto-inflate life jackets & 2 harnesses
- Lifebuoys: 1
- EPIRB: 2 x PLB
- Flares: Expired
- Fire Extinguishers: 6
- Gas Detector
- Radar Reflector
- Bilge Pumps: Manual & Electric
- Fire Blanket

CANVAS

- Sprayhood: NEW
- Bimini
- Cockpit Cushions
- Dinghy: Seago 2.8m Hypalon
- Warps & Fenders

TENDER

MISCELLANEOUS

TITLE DOCUMENTS AND TAX

Listed below are the documents/or copies which we have seen on listing this yacht:

- SSR Registration
- Hull Number: DE-BAVC38M3B999
- EU VAT proof
- Builders Certificate
- Full chain of title Bills of Sale
- Greek Transit log UNLIMITED
- Wind/depth/speed instruments not fully functional & speed reads on chartplotter
- Forward tank leaks if filled above 100% & tank gauges show levels

HISTORY

Baleine has had two previous owners. The current owners have used her extensively for cruising around South UK, Brittany, Biscay, Spain, Portugal, Morocco, Italy, Greece, and Turkey & spending eight years enjoying the Greek islands. She has been under constant maintenance with regular upgrades and is now based in Preveza, Greece, ready for the next chapter.

Mechanical

CONSTRUCTION

- Type: Sailing yacht & Bavaria 38 Ocean CC
- Builder: Bavaria
- Designer: J&J Design
- Year Built: 1999
- Construction: GRP hull and deck

• Superstructure: GRP
• Hull Colour: White
• Rudder Type: Spade
• Keel Type: Lead keel with bulb
• Helm Position: Centre cockpit
• Last Survey: 2015</p><p>DIMENSIONS</p><p>• LOA: 11.55?m
• Beam: 3.99?m
• Draft: 1.55?m
• Displacement: 8 tonnes</p><p>MECHANICAL</p><p>• Engine: Volvo MD22L (1999)
• Horsepower: 50 HP
• Drive Type: Saildrive
• Fuel Type: Diesel
• Cooling: Fresh water
• Propeller: Max prop + spare
• Rope Cutter: Stripper
• Last Engine Service: Ongoing, constant maintenance</p><p>PERFORMANCE</p><p>• Cruising Speed: 6 knots @ 2000 RPM
• Max Speed: 7 knots @ 2400 RPM</p><p>TANKAGE</p><p>• Fuel: 220 litres (stainless steel)
• Water: 2 x 200 litres (plastic)
• Holding Tank: 50 litres (stainless steel)</p><p>ELECTRICAL</p><p>• Domestic Batteries: 4 x 120Ah (1 year old)
• Starter Battery: 125Ah (6 months old)
• Alternator: 60A
• Inverter: Small inverter
• Solar: 4 x Solbian panels (480W total) (2016)
• Shore Power
• Battery Charger: 48A</p><p>RIGGING</p><p>• Rig Type: Sloop
• Mast/Spars: Selden aluminium
• Mainsail Reefing: In-mast
• Furling Headsail</p><p>SAILS</p><p>• Main (2007) – Good
• Genoa (2007) – Serviceable
• Storm Sail (2008) – Unused
• Cruising Chute – Good condition</p></p>







BAVARIA 38 Ocean

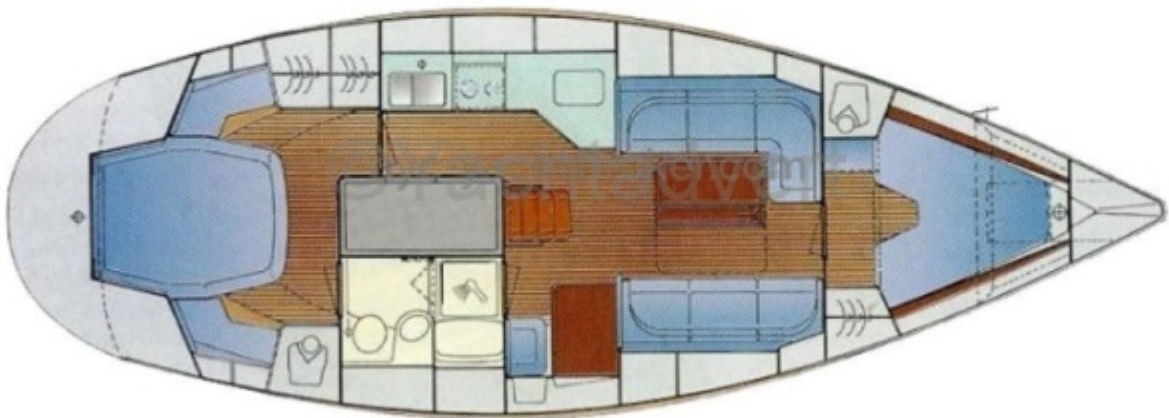

Center cockpit version/ Version cockpit central



BAVARIA 38 Ocean

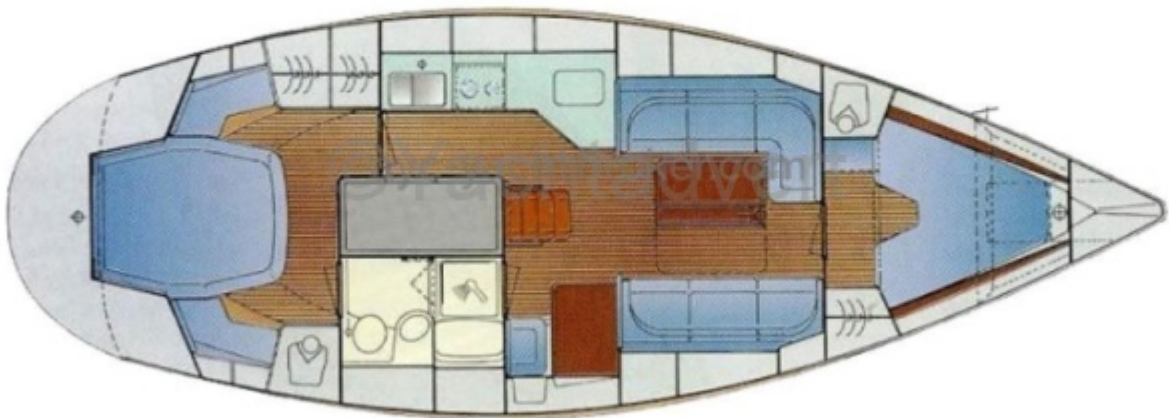

Center cockpit version/ Version cockpit central

BAVARIA 38 Ocean

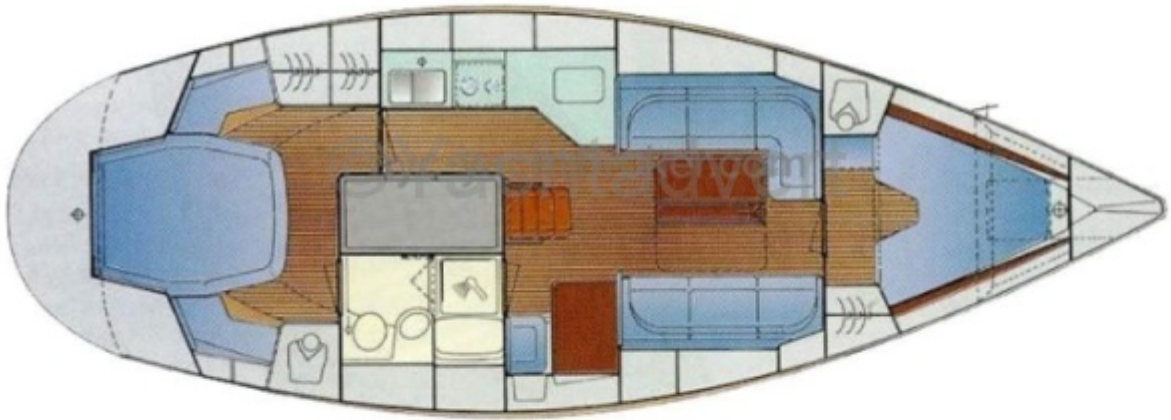

Center cockpit version/ Version cockpit central



BAVARIA 38 Ocean

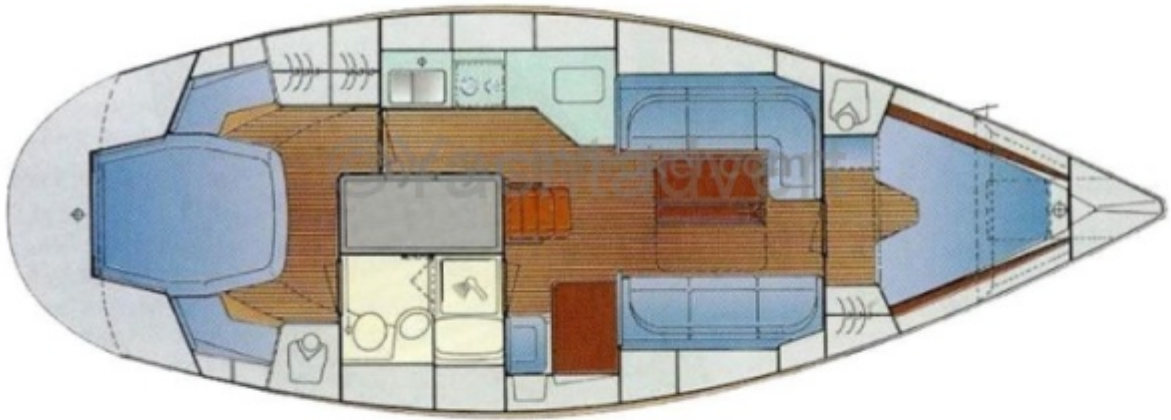

Center cockpit version/ Version cockpit central























































































