



11 - 2021

<https://www.yachtadvert.com/fr/2840-excess-11.html>

335 000 EUR ttc



Général

Constructeur : Excess
Longueur : 11,58 m
Tirant d'eau : 0,00 m
Région : Lefkada, Grèce

Sous type : Plaisance
Année : 2021
Largeur : 6,71 m
Radeau : Non
Leasing en cours : Non

Moteurs

Aménagements

Flybridge : Non

Timonerie : Non

électronique

Pilote auto : Non

GPS : Non

VHF : Non

Déssalinisateur : Non

Radar : Non

Sondeur : Non

Traceur de carte : Non

Convertisseur 12/220 : Non

équipement de pont

Hydraulique : Non

Plateforme AR : Non

Taud d'hivernage : Non

Capote de roof : Non

Cockpit en teck : Non

Grand voile sur enrouleur : Non

Passerelle : Non

Bossoirs : Non

Guindeau électrique : Non

Taud cockpit : Non

Pont teck : Non

Génois sur enrouleur : Non

Spinnaker : Non

équipements principaux

Propulseur Arrière : Non

Clim. : Non

Eaux noires : Non

Annexe : Non

Propulseur avant : Non

Groupe élec. : Non

Eau chaude : Non

Flaps : Non

Moteur annexe : Non

électroménager

Congélateur : Non
Micro-ondes : Non
Réchaud électrique : Non
Lave-linge : Non
Antenne TV : Non
TV SAT : Non

Glaçons : Non
Four : Non
Réchaud gaz : Non
Chauffage : Non
Lave-vaisselle : Non
TV : Non

Divers

Remarks :

DESCRIPTION

2021 Excess 11 sailing yacht, currently lying in Lefkas Marina and presented in a well-equipped, ready-to-use condition. This modern catamaran combines sporty sailing performance with a practical, easy-to-manage layout, making it an excellent option for relaxed island hopping with family and friends.

The yacht offers a versatile accommodation arrangement with four double guest cabins, two additional single berths in the bow compartments, and a convertible saloon, comfortably sleeping up to ten. The cockpit and helm areas are well designed for sociable time on board, featuring twin helm stations, full exterior cushions, biminis, and a spacious aft seating area with excellent storage.

Powered by twin Yanmar 29HP engines, both recently serviced in December 2025 along with the sail drives, she benefits from a reliable and efficient setup. The sail plan includes a square top mainsail and self-tacking jib, making her straightforward to handle whether short-handed or with guests on board.

A strong specification includes Raymarine navigation electronics, solar panels with Victron charging, AGM battery bank, electric toilets, hot water system, and a full inventory of cruising equipment. Supplied with a 2.90m RIB tender (2025) and Honda outboard, she is fully equipped for immediate use.

Highlights:

- 2021 Excess 11

- Located in Lefkas Marina

- 4 cabins plus 2 bow berths

- Sleeps up to 10

- Twin Yanmar engines (serviced December 2025)

- Sail drives serviced (December 2025)

- Square top mainsail and self-tacking jib

- Raymarine navigation suite

- Solar panels with Victron system

- Electric toilets and hot water

- Full exterior cushions and cockpit setup

- 2.90m RIB tender (2025) with Honda outboard

- Ready for immediate cruising

BROKER'S REMARKS

This Excess 11 offers a very appealing balance of modern styling, enjoyable sailing performance, and practical day-to-day usability. The twin helm arrangement keeps the cockpit open and social, while still giving the helmsman good visibility and control, making her particularly well suited to relaxed cruising with family and friends.

The layout is one of her strongest points, with four comfortable double cabins, additional bow berths for flexibility, and a bright, open saloon. On deck, the generous seating areas, full cushion package, and well-protected helm stations create an easy, sociable environment whether at anchor or underway.

Accommodation :

CONSTRUCTION

- Builder: Excess Catamarans

- Model: Excess 11

- Year: 2021

- Hull type: Catamaran

- Hull material: GRP

- • Deck and superstructure: GRP
- • Steering: Twin helm stations
- • Colour scheme: Light hull with graphite exterior upholstery
- • Flag: Greek
- • **DIMENSIONS**
- • LOA: 11.42m (37ft 6in)
- • Beam: 6.59m (21ft 7in)
- • Draft: 1.15m (3ft 9in)
- • **MECHANICAL**
- • Engines: 2 x Yanmar 29HP (3YM30AE)
- • Engine service: Yanmar serviced (December 2025)
- • Sail drives: SD25
- • Sail drives serviced and oil change (December 2025)
- • Propellers: 3-blade fixed (16 x 13)
- • Steering: Twin helm with leather covered wheels
- • **PERFORMANCE**
- • Cruising speed: Approx. 6 knots
- • Engine consumption: Approx. 8L/hour
- • **TANKAGE**
- • Fuel capacity: 440L
- • Fresh water capacity: 600L
- • Holding tanks: 2 x 80L
- • **ELECTRICAL**
- • Solar panels with Victron smart charging system
- • Charge controller: Victron BlueSolar MPPT 75/15
- • Batteries: AGM
- • Service batteries: 4 x 140Ah
- • Engine batteries: 2 x 140Ah
- • Shore power: 32A
- • 220V sockets throughout
- • USB sockets in cabins, saloon and cockpit
- • Electric water heater
- • **SAILS**
- • Full batten square top mainsail (Dacron) with lazy bag (Graphite)
- • Self-tacking jib (Dacron with UV strip)
- • Mainsail area: Approx. 55m²
- • Jib area: Approx. 22m²
- • **NAVIGATION**
- • Raymarine Axiom 7" display
- • Raymarine i70s displays
- • Raymarine p70 autopilot control
- • Raymarine autopilot system
- • Raymarine Ray90 VHF
- • GPS plotter
- • Depth sounder
- • Speed log
- • Wind system
- • Navigation tools and chart package
- • **DECK**
- • Electric windlass (Quick 1000W)
- • Anchor 20kg
- • 75m chain
- • 20m warp
- • Spare anchor and chain
- • Stainless steel davits
- • Stainless steel biminis (port and starboard helm)
- • Cockpit table (GRP)
- • L-shaped cockpit seating
- • Aft beam seating with large storage locker

- • Full exterior cushion set (Graphite)
- • Forward sunbathing cushions
- • Aft cockpit cushions
- • Stern sunshade tent
- • Deck lighting and indirect interior lighting
- • Cockpit shower (hot and cold)
- • Swim ladder (stainless steel)
- • Gangway (wooden)
- • Mooring kit (lines and fenders with covers)
- • Boat hook, hoses, winch handles and deck equipment
- • EPIRB
- • Liferaft (10 person)
- • Lifejackets (adult and child)
- • Fire extinguishers
- • Distress flares and signalling equipment
- • Horseshoe lifebuoy
- • Floating light and fog horn
- • Radar reflector
- • Safety harnesses
- • Emergency tiller
- • Wire cutters and safety equipment
- • 4 double guest cabins
- • 2 bow single cabins
- • 2 heads with separate showers
- • 1 additional bow head
- • Saloon convertible to double berth
- • Sleeps up to 10

LAYOUT

The yacht features a practical and well-balanced layout with four double cabins arranged across both hulls, each pair sharing a head with separate shower. The addition of two bow cabins provides flexibility for occasional guests or storage, while the convertible saloon offers extra sleeping space when required. The saloon is bright and open, flowing directly into the cockpit for easy indoor-outdoor living.

TENDER

- • 2.90m RIB tender (2025)
- • Honda 5HP 4-stroke outboard

MISCELLANEOUS

- • Fusion audio system (saloon and cockpit)
- • Snorkelling equipment
- • Binoculars
- • Tool kit and spare parts
- • Sail repair kit
- • Cleaning equipment
- • Boat manuals

Inventory :

Mechanical :





















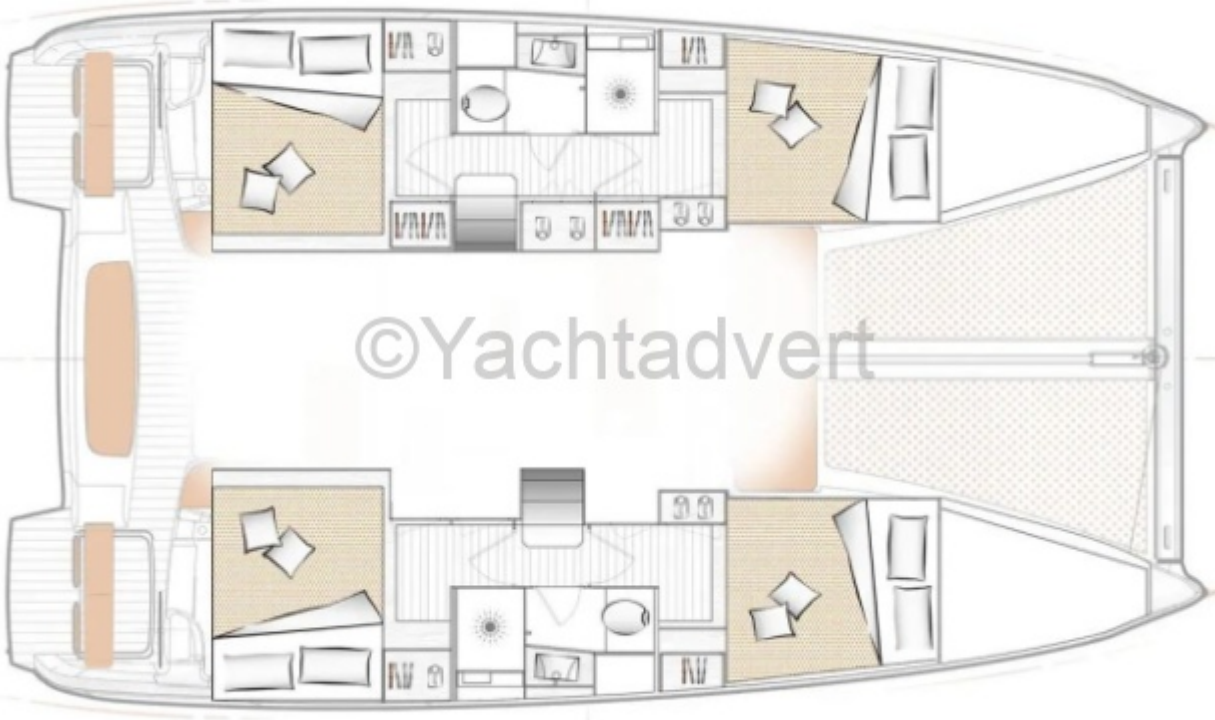

©Yachtadvert