



54 - 2014

<https://www.yachtadvert.com/fr/795-alibi-54.html>

682 990 â,- ttc



## Général

Constructeur : Alibi  
Matériau : GRP Poly  
Largeur : 28,00 m  
Radeau : Non  
Leasing en cours : Non

Sous type : Plaisance  
Année : 2014  
Longueur : 54,00 m  
Tirant d'eau : 0,00 m  
Région : Preveza, Grèce

## Moteurs

Carburant : Diesel  
Puiss. Unit. (CV) : 50

Marque moteur : BETA  
Nombre : 2

# Aménagements

Flybridge : Non

Timonerie : Non

---

## électronique

Pilote auto : Non

GPS : Non

VHF : Non

Déssalinisateur : Non

Radar : Non

Sondeur : Non

Traceur de carte : Non

Convertisseur 12/220 : Non

---

## équipement de pont

Hydraulique : Non

Plateforme AR : Non

Taud d'hivernage : Non

Capote de roof : Non

Cockpit en teck : Non

Grand voile sur enrouleur : Non

Passerelle : Non

Bossoirs : Non

Guindeau électrique : Non

Taud cockpit : Non

Pont teck : Non

Génois sur enrouleur : Non

Spinnaker : Non

---

## équipements principaux

Propulseur Arrière : Non

Clim. : Non

Eaux noires : Non

Annexe : Non

Propulseur avant : Non

Groupe élec. : Non

Eau chaude : Non

Flaps : Non

Moteur annexe : Non

---

# électroménager

Congélateur : Non  
Micro-ondes : Non  
Réchaud électrique : Non  
Lave-linge : Non  
Antenne TV : Non  
TV SAT : Non

Glaçons : Non  
Four : Non  
Réchaud gaz : Non  
Chauffage : Non  
Lave-vaisselle : Non  
TV : Non

---

## Divers

**Remarks :**

**Licence to Chill** is a truly remarkable Alibi 54 catamaran, originally designed by a top Australian racer to be the ultimate dream yacht for global cruising. This unique owner-version layout has been meticulously maintained, with its current owner enjoying high-speed adventures across the Mediterranean. Now, due to a change in plans, this extraordinary vessel is available for sale at an unbeatable value. Priced **\$30,000** below its original listing, Licence to Chill offers an unparalleled opportunity to own a high-performance catamaran that's ready to sail. Comparable new models with the same features would cost at least 1.55 million Euros, excluding construction expenses. This yacht is packed with premium features, including a rotating carbon mast, a brand-new mainsail and genoa, multiple sails and winches, a water maker, generator, and an extensive array of safety and electronic equipment. If you're in the market for a fully-equipped, adventure-ready catamaran, Licence to Chill is a must-see.

### Highlights

- \$30,000 price reduction** &mdash; exceptional value!
- Unique owner-version layout for optimal comfort and performance
- Rotating carbon mast for enhanced sailing capabilities
- New mainsail and genoa included
- Comprehensive sail inventory and winches
- Equipped with a water maker and generator
- Advanced safety and electronic gear on board
- Ideal for those seeking a high-performance, ready-to-sail catamaran

**Accommodation :**

**ACCOMMODATION**

- Owner Version
- 3 cabins
- Sleeps 6+ pax
- Interior finish: &nbsp;paint
- Flooring: &nbsp;External White/Non-Skid, Internal/Laminate
- Sunbrella salon couch and fabric
- Salon table: &nbsp;Carbon, Black
- 2 heads
- 2 showers
- Various cabinets/hanging lockers/interior lighting
- Navigation station
- Dessalator MR4-200L watermaker
- a/c: &nbsp;portable units&nbsp;
- Nautic 83 hot water heater, 80L boiler
- Caframo cabin fans x3

**GALLEY**

- Refrigerator: &nbsp;1x Miele 100L and 1x Isotherm 100L
- Freezer: Miele 97 litre
- Sink: Stainless steel sink with stone cover
- Saltwater pump
- Stove: &nbsp;Miele Induction cooktop - 3 burner
- Oven: Miele Microspeed oven + microwave
- Stone countertops ~ Black

**Disclaimer**

The Company offers the details of this vessel in good faith but cannot guarantee or warrant the accuracy of this information nor warrant the condition of the vessel. A buyer should instruct his agents, or his surveyors, to investigate such details as the buyer desires validated. This vessel is offered subject to prior sale, price change, or withdrawal without notice.

**Inventory :**

**DECK**

- Winches: &nbsp;Harken 60x2, Harken 46x3 (all electric)
- Constrictor Rope clutches
- 2 bow pulpit seats
- Helm cover
- Winch covers
- Lewmar opening hatches
- Various UV hatch covers
- Dock lines
- Cockpit seating and table
- Cockpit cushions
- Deck shower: &nbsp;In transom, freshwater
- Fixed Bimini
- Harken Traveler
- Stack pack with lazy jacks
- Custom low profile sail cover
- Harken switch batten cars

**TENDER**

- Bumpers: &nbsp;Certec inflatable with covers x6
- Highfield 3.2 M &nbsp;Light Aluminium RIB
- Under boat storage of tender
- Dinghy Engine: &nbsp;Mercury

**Mechanical :**

**DIMENSIONS**

- Brand: &nbsp;Alibi
- Model: &nbsp;54
- Designer: &nbsp;Alibi
- Launched &nbsp;&nbsp; Registered: &nbsp;2015
- Hull material: &nbsp;Epoxy
- LOA: &nbsp;16.25m
- Beam: &nbsp;8.40m
- Draft: &nbsp;.80m
- Displacement: &nbsp;Approximately 14 tons loaded
- Cruising speed under power: &nbsp;Approximately 6-8 kts
- Max speed under power: &nbsp;Approximately 10 kts
- Sailing speed: 9 to 20 plus knots. Averages at least 10 to 12 knots.
- Drive type: &nbsp;shaft
- Propellers -2 x Maxi prop folding 3 blade

**TANKAGE**

- Fuel: &nbsp;450L Tank x1 + 150L Tank x1
- Water: &nbsp;450L
- Holdings: &nbsp;1x grey water tank + 1x black water tank

**ELECTRONICS**

- GPS: B&nbsp;&nbsp;G
- Depth sounder: Airmar
- Wind speed + direction model: B&nbsp;&nbsp;G H5000
- Autopilot: &nbsp;Lecombe &nbsp;&nbsp; Schmidt
- VHF Radio: B&nbsp;&nbsp;G V40
- Radar: &nbsp;B&nbsp;&nbsp;G
- Chartplotter: &nbsp;B&nbsp;&nbsp;G Zeus12
- Compass: RC42

**MECHANICAL AND ELECTRICAL**

- 2 x Beta Marine 50 HP
- Engines fitted 2016 and approx 900 hours
- Generator: &nbsp;Beta Gen 11kw
- Generator hours: &nbsp;34
- Shore power cord
- Charger system: &nbsp;Quattro charger/inverter x2
- Alternator: &nbsp;Beta 24V, 100 AMP x2
- Electrical socket: &nbsp;International
- Battery system: 21kW, Lithium Battery Bank - Victron monitor, EV power BMS
- Shaft with Folding 4 blade props

**RIGGING &nbsp;&nbsp; SAILS**

- Mainsail:&nbsp; NEW 2024
- 112m2
- Jib: New 2023 , 43m2 furling
- Asymmetrical spinnaker: Quantum/Furling
- Excellent condition
- Code 0: &nbsp;Quantum/Furling &nbsp;- Aramida polyester
- Mast: &nbsp;Lorima, Carbon, Rotating
- Bowsprit: Major carbon structure
- Various furlers including Facnor



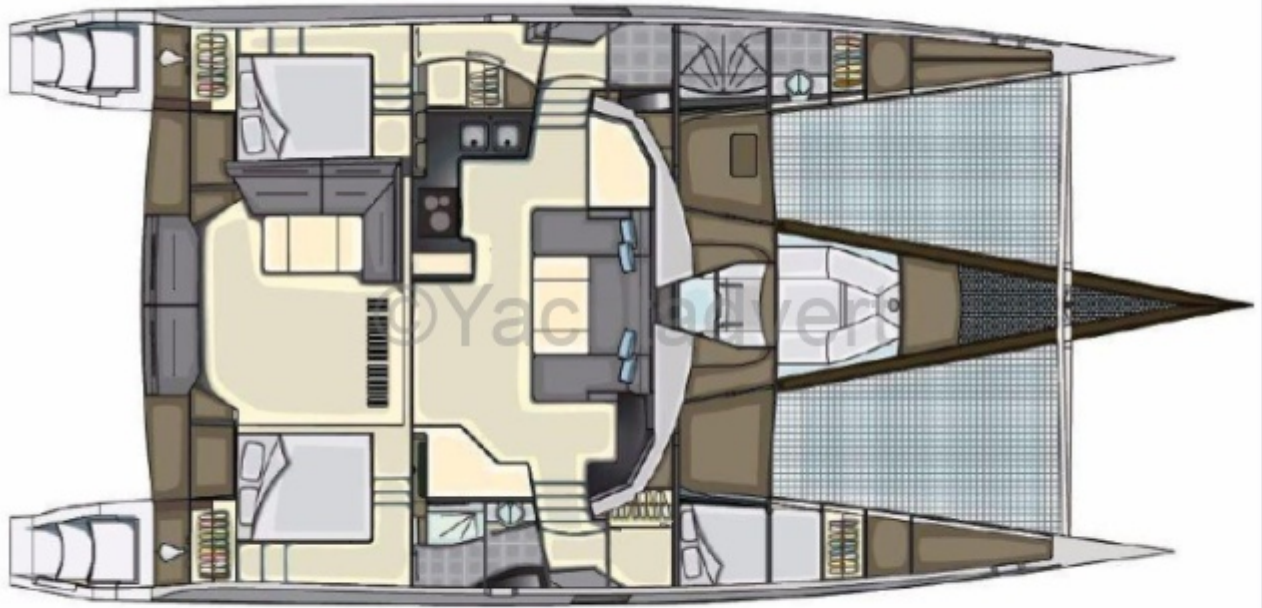

24 x 11,99 m

































