



545 - 2010

<https://www.yachtadvert.com/1056-hanse-545.html>

259 500 EUR incl vat



General

Builder : Hanse

Material : GRP

Beam : 16.00 Ft

Life Raft : No

Leasing in progress : No

Subtype : Pleasure

Year : 2010

Length : 54.00 Ft

keel : Fin keel

Area : Preveza, Greece, Greece

Engines

Fuel : Diesel

Power Unit. (HP) : 82

Engine Brand : Yanmar

Engine(s) : 1

Facilities

Flybridge : No

Helm : No

Electronics

Autopilot : No

GPS : No

VHF : No

Watermaker : No

Radar : No

Sounder : No

Chartplotter : No

Converter 12/220 : No

Bridge equipment

Hydraulic Gangway : No

Bath platform : No

Winter cover : No

Sprayhood : No

Teak cockpit : No

Furling mainsail : No

Gangway : No

Davits : No

Electric windlass : No

Cockpit awning : No

Teak deck : No

Furling genoa : No

Spinnaker : No

Main equipment

Stern thruster : No

AC : No

Black Water : No

Tender : No

Bow Thruster : No

Marine Generator : No

Hot water : No

Flaps : No

Tender Engine : No

Household appliances

Freezer : No

Microwaves : No

Electric stove : No

Washing machine : No

TV antenna : No

SAT-TV : No

IceMaker : No

Oven : No

Gas stove : No

Heater : No

Dishwasher : No

TV : No

Various

Remarks :

Hanse 545 (2010) – EU VAT Paid | Lightly Used | Lying Greece</p><p>Delivered new in 2010 and privately owned since 2015, this is an exceptionally well-kept example of the popular Hanse 545, designed by Judel/Vrolijk and built in Germany. Originally used as a factory demonstrator, she has since been cruised lightly and maintained to a high standard by a single private family ownership.</p><p>She offers the perfect balance of performance, comfort, and simplicity, with the Hanse Easy Sailing system — self-tacking jib, in-mast furling, and electric winches — making her easily handled by a couple. Below, the interior is bright, modern, and well laid out for extended living aboard, with three generous cabins, two heads with separate stall showers, a long galley, and excellent ventilation throughout.</p><p>Low engine and generator hours, VAT paid status, and a recent round of smart upgrades — including a new watermaker and radar system (Winter 2024/25) — complete the package.</p><div align="center"><hr align="center" size="2" width="100%"></div><p>Highlights</p>Yanmar 110 hp engine – only 1,031 hoursFischer Panda generator – approx. 400 hoursEU VAT paid – privately owned and well documentedNew watermaker and new radar (Winter 2024/25)North Sails (2016) in excellent conditionIn-mast furling mainsail and self-tacking jib3 electric winches – Easy Sailing setupAir conditioning (3 x Clima Vega Mk3 units)3 double cabins / 2 heads with separate shower stallsTeak deck in excellent conditionDrop-down transom with tender garageSail locker forward, convertible to skipper cabinLG washer-dryer fitted<p> </p><p>Why She Stands Out</p><p>Few examples of the Hanse 545 come to market with such light use and thoughtful upgrades already in place. The combination of low maintenance hours, a cruising-friendly layout, and equipment like air conditioning, a tender garage, and a washer-dryer make her ideal for extended Mediterranean seasons or offshore passages.</p><p>With her clean lines, flush deck, and German build quality, she offers both sailing pleasure and excellent onboard comfort.</p><p> </p><p>Broker’s Remarks</p><p>A very well-maintained and sensibly upgraded Hanse 545 with EU VAT paid, low hours, and key systems already renewed. Well suited to sailors looking for a stylish, capable cruiser with the features needed for independent Mediterranean cruising.</p>Accommodation :</div>

ACCOMMODATION

- 3 cabins, 2 heads (both with separate shower stalls)
- Forward owner’s cabin with island berth
- Ensuite heads with stall shower
- Two aft cabins (starboard double, port Pullman)
- Aft heads with stall shower
- Bright saloon with L-sofa

- • Lounge seating to starboard
- • Galley to starboard
- • Nav station to port
- • Mahogany joinery
- • LED lighting
- • Ivory upholstery
- • Cabin and saloon fans

LAYOUT

Owner's cabin forward with ensuite. Saloon amidships, galley to starboard, nav station to port. Two aft cabins and aft heads with shower. Forward sail locker accessible from deck.

DOMESTIC

- • Corian worktop with split sinks
- • 130L top/front-opening fridge
- • Gimballed gas cooker
- • Air conditioning (3 units – Clima Vega Mk3)
- • Jabsco toilets
- • LG Direct Drive 5 kg / 2.5 kg washer-dryer
- • Cockpit cushions
- • Sprayhood (Masacril dark grey)
- • Bimini (Masacril dark grey)

TENDER

- • Sea covers and wheel covers
- • Tender garage (no tender included)

MISCELLANEOUS

- • Removable inner forestay
- • Spinnaker pole
- • Full manuals onboard
- • Winter upgrade programme
- • EU VAT PAID

Inventory :

SAFETY

- • Manual and electric bilge pumps
- • Fire extinguishers
- • Jackstays
- • Emergency tiller
- • Navigation and anchor lights
- • Life raft (service status to be checked)

EXTRA DETAILS

- • One private owner
- • Ex-Hanse show yacht
- • Light Mediterranean cruising
- • Strong maintenance history

TITLE DOCUMENTS AND TAX

Listed below are the documents we have reviewed:

- • Builder's Certificate
- • RCD Certificate of Conformity
- • UK Part I Registration Certificate (expired)
- • EU VAT Invoice (German dealer to owner)
- • Bill of Sale – Hanse to owner
- • Full equipment manuals onboard

VAT STATUS: EU VAT PAID

KNOWN DEFECTS

None

HISTORY

Built in 2010, used as a Hanse factory show yacht, then sold to current owners in 2015. Lightly cruised in the Mediterranean with professional maintenance. Winter upgrade programme underway.

Mechanical :

CONSTRUCTION

Sloop rigged with a removable inner forestay

Engine Number: E123894

HIN: DE-HANS0209B010

VAT STATUS: EU VAT PAID

- • Vacuum-bagged pre-preg E-glass with epoxy
- • Corecell foam-cored topsides
- • GRP structural grid bonded to hull
- • GRP ring frames tabbed to hull and deck
- • Deck: balsa-core GRP with teak overlay
- • Vinylester osmosis-resistant outer skin
- • Hull-deck shoebox joint bonded and mechanically fastened
- • Flush deck hatches and coachroof windows</p><p>DIMENSIONS
- • LOA: 16.20 m (53 ft 2 in)
- • LWL: 14.60 m (47 ft 11 in)
- • Beam: 4.91 m (16 ft 1 in)
- • Draft: 2.43 m (7 ft 11 in)
- • Displacement: approx. 20,200 kg
- • Ballast: approx. 5,808 kg</p><p>MECHANICAL
- • Yanmar 4JH4-HTE1 diesel (110 hp)
- • Engine hours: 1,031
- • Engine Number: E123894
- • Shaft drive, 3-blade bronze propeller
- • Fischer Panda generator approx. 400 hours
- • Retractable bow thruster
- • Hot/cold pressurised water
- • Winter 2024/25 upgrades: new watermaker and radar</p><p>PERFORMANCE
- • Judel/Vrolijk performance hull
- • Excellent for single/short-handed use
- • In-mast furling mainsail
- • Self-tacking jib
- • Removable inner forestay
- • Spinnaker pole</p><p>TANKAGE
- • Fuel approx. 375 litres
- • Water approx. 690 litres
- • Holding tanks fitted</p><p>ELECTRICAL
- • Domestic battery bank: 4 × 165 Ah
- • Shore power
- • Battery charger and inverter
- • Fischer Panda generator approx. 400 hours
- • LED lighting
- • 230V sockets
- • 12V outlets
- • Electrical panels at nav station</p><p>RIGGING
- • Aluminium 3-spreader mast
- • Sloop rigged with a removable inner forestay
- • In-mast furling
- • Self-tacking jib track
- • Furlex 400 genoa furler
- • Removable inner forestay
- • Spinnaker pole
- • Rod kicker
- • Stainless steel standing rigging (original)
- • All running rigging led aft</p><p>SAILS
- • Mainsail – in-mast furling (North Sails 2016, excellent)
- • Self-tacking jib (North Sails 2016, excellent)
- • Furling genoa (Furlex 400)
- • Additional sails in forward locker</p><p>NAVIGATION

- • B&G chartplotter (nav station)
- • B&G/Simrad chartplotter (helm)
- • Simrad AP24 autopilot
- • Simrad IS20 wind/speed/depth
- • AIS transceiver
- • Lewmar AA560 chain counter
- • Compass
- • Radar upgrade planned Winter 2024/25
- • Navigation lights</p><p>DECK
- • Full teak deck, excellent
- • Twin helm stations with seating
- • Lewmar 54 electric primary winches
- • Lewmar 54 electric coachroof winch
- • Lofrans Project 1000 electric windlass
- • Electric capstan on foredeck
- • Cockpit table
- • Cockpit cushions
- • Forward sail locker (convertible)
- • Fold-down transom swim platform with tender garage
- • Hot/cold deck shower
- • Stainless swim ladder</p>





HANSE 545 3 Cabin version

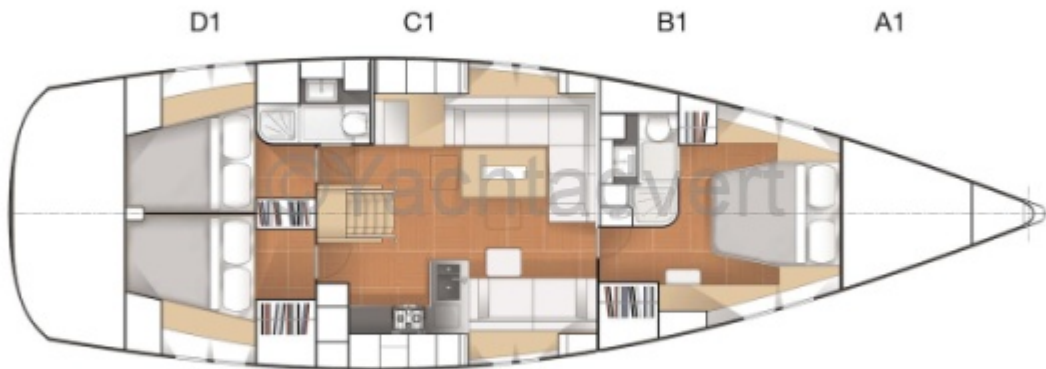

HANSE 545 3 Cabin version

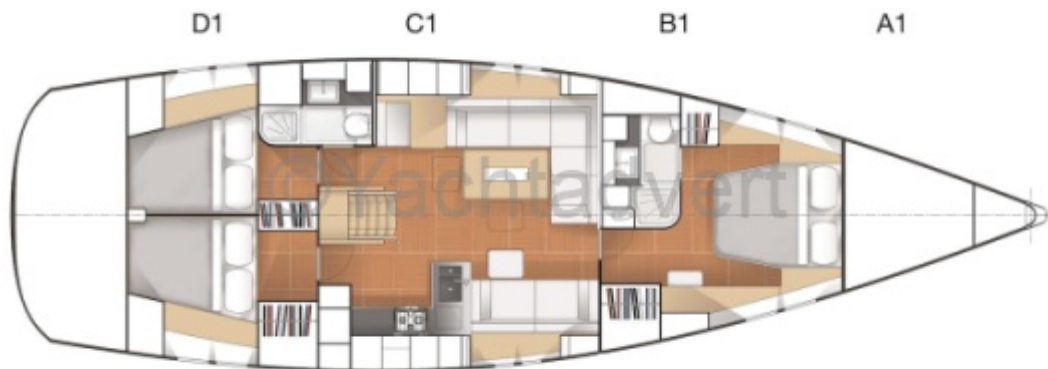

HANSE 545 3 Cabin version

