



# BAVARIA 31 SPORT - 2012

<https://www.yachtadvert.com/1594-bavaria-31-sport.html>

69 000 EUR incl vat



## General

Year : 2012

Beam : 10.86 Ft

Life Raft : No

Leasing in progress : No

Builder : Bavaria

Length : 33.01 Ft

Hull : Monohull

Area : Charente-Maritime, France

## Engines

Model : 5.0 MPI

Power Unit. (HP) : 225

Shaft : Z drive

Engine Brand : MERCUISER

Engine(s) : 2

Hours : 750

Tank : 520 L

## Facilities

Head : 1  
Berth : 6  
Flybridge : No

Double Cabin : 2  
WC : Sailor  
Helm : No

---

## Electronics

Autopilot : Yes  
GPS : Yes  
VHF : Yes  
Watermaker : No

Radar : No  
Sounder : Yes  
Chartplotter : No  
Converter 12/220 : No

---

## Bridge equipment

Hydraulic Gangway : No  
Bath platform : No  
Winter cover : Yes  
Sprayhood : No  
Teak cockpit : Yes  
Furling mainsail : No

Gangway : No  
Davits : No  
Electric windlass : Yes  
Cockpit awning : Yes  
Teak deck : Yes  
Furling genoa : No  
Spinnaker : No

---

## Main equipment

Stern thruster : No  
AC : Yes  
Black Water : No  
Tender : No

Bow Thruster : Yes  
Marine Generator : No  
Hot water : No  
Flaps : No  
Tender Engine : No

---

## Household appliances

Freezer : No

Microwaves : Yes

Electric stove : No

Washing machine : No

TV antenna : No

SAT-TV : Yes

IceMaker : No

Oven : Yes

Gas stove : No

Heater : Yes

Dishwasher : No

TV : Yes

---

## Various

<p>XBOAT ref :3853.

I am selling my 2012 BAVARIA 31 SPORT.

It is equipped with MERCUISER 5.0L MPI engines (2 x 225HP) maintained by a local professional, bow thruster, reversible air conditioning, convertible saloon, TV in the owner's cabin, oven and electric hob, 2 refrigerators, black water tank, converter, recent batteries...

The exterior layout of the BAVARIA 31 SPORT remains true to its predecessors with a spacious deck featuring a large aft sunbathing area leading to the swim platform, a "U"-shaped dining area, a galley, and of course the helm station.

The main originality of this sporty motor yacht lies in the cabin.

Indeed, BAVARIA has managed to combine in the interior saloon a dining area and an open berth without reducing the volume of the galley and especially of the aft cabin, which remains as spacious as ever.

The BAVARIA 31 Sport thus offers a good compromise between comfort and functionality.

It can accommodate up to 8 people on board.

It is a versatile motor yacht, suitable for relaxing coastal cruises or sporty outings.

Video tour available on this page.

More details and visit upon request. More details and pictures on [xboat.uk](http://xboat.uk)</p>







©Xboat

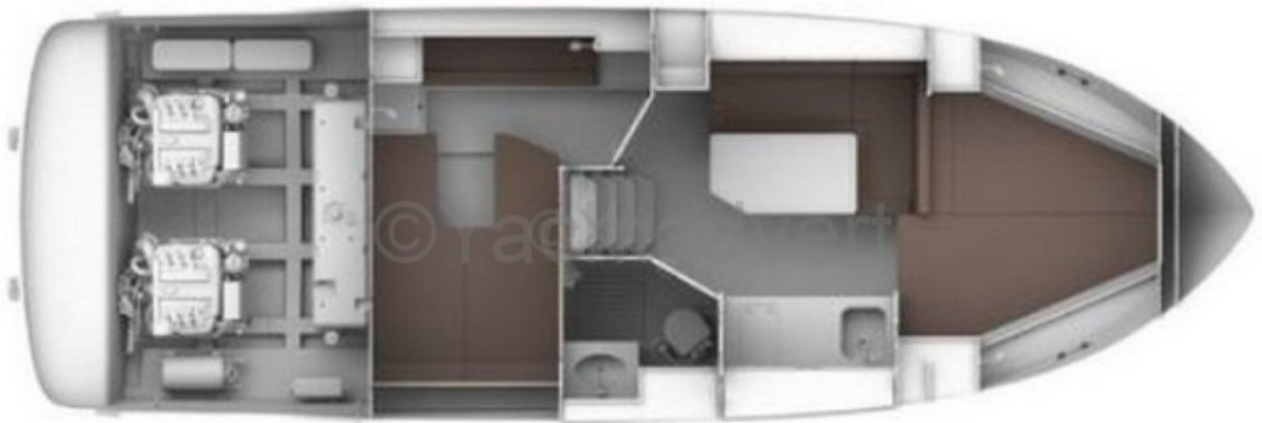

©Xboat















