



## 38 Ocean - 1999

<https://www.yachtadvert.com/2100-bavaria-38-ocean.html>

75 000 EUR incl vat



### General

Year : 1999  
Length : 37.00 Ft  
Draft : 0.00 Ft  
Area : Preveza, Greece

Builder : Bavaria  
Material : GRP  
Beam : 13.00 Ft  
Life Raft : No  
Leasing in progress : No

### Engines

Fuel : Diesel  
Power Unit. (HP) : 50

Engine Brand : Volvo MD22L  
Engine(s) : 1

## Facilities

Flybridge : No

Helm : No

---

## Electronics

Autopilot : No

GPS : No

VHF : No

Watermaker : No

Radar : No

Sounder : No

Chartplotter : No

Converter 12/220 : No

---

## Bridge equipment

Hydraulic Gangway : No

Bath platform : No

Winter cover : No

Sprayhood : No

Teak cockpit : No

Furling mainsail : No

Gangway : No

Davits : No

Electric windlass : No

Cockpit awning : No

Teak deck : No

Furling genoa : No

Spinnaker : No

---

## Main equipment

Stern thruster : No

AC : No

Black Water : No

Tender : No

Bow Thruster : No

Marine Generator : No

Hot water : No

Flaps : No

Tender Engine : No

---

# Household appliances

Freezer : No

Microwaves : No

Electric stove : No

Washing machine : No

TV antenna : No

SAT-TV : No

IceMaker : No

Oven : No

Gas stove : No

Heater : No

Dishwasher : No

TV : No

---

## Various

**Remarks :**

This a Bavaria 38 Ocean Centre Cockpit yacht, well-suited to comfortable long-distance cruising. She has benefitted from conscientious private ownership and regular maintenance, including recent upgrades to batteries and canvas. Designed by J&J Design and built in Germany, she delivers reliable performance, a solid build, and a practical layout. Her spacious teak-decked cockpit, in-mast furling, and wide beam make her ideal for effortless island hopping with family or friends.

**Highlights Listed below but included in Full Specs:**

• Bavaria 38 Ocean Centre Cockpit, 1999

• Volvo MD22L 50hp diesel engine (1999)

• In-mast furling with good sail inventory

• 2 double cabins + 2 saloon singles

• New batteries

• Raymarine chartplotter (2021)

• Sprayhood (new), cockpit cushions, and teak decks

• Based in Preveza, Greece – ready for immediate cruising

**Accommodation :**

• **ACCOMMODATION**

• Cabins: 2 double cabins + saloon with 2 singles

• Berths: 6

• Headroom: Approx. 6 ft

• Upholstery: Fabric

• Heating: Eberspacher forced air

• Heads: 1 manual

• Shower: 1 plus deck shower

• Hot Water: Yes – calorifier/immersion

• Galley: Pressurised water, gas hob, oven, galley sink, fridge

**LAYOUT**

Centre cockpit layout with spacious aft double cabin and forward guest cabin, both offering good privacy. Saloon converts to additional sleeping if needed, with generous seating and a practical L-shaped galley to port.

**DOMESTIC**

Plenty of storage throughout.

• **Disclaimer**

The Company offers the details of this vessel in good faith but cannot guarantee or warrant the accuracy of this information nor warrant the condition of the vessel. A buyer should instruct his agents, or his surveyors, to investigate such details as the buyer desires validated. This vessel is offered subject to prior sale, price change, or withdrawal without notice.

**Inventory :**

• **NAVIGATION**

• Chart Plotter: Raymarine (2021)

• Wind Instrument: Raytheon (requires replacement)

• GPS: Raytheon RL70

• AIS: Not connected



- &bull; Rudder Type: Spade
- &bull; Keel Type: Lead keel with bulb
- &bull; Helm Position: Centre cockpit
- &bull; Last Survey: 2015</p><p><strong>DIMENSIONS</strong>
- &bull; LOA: 11.55?m
- &bull; Beam: 3.99?m
- &bull; Draft: 1.55?m
- &bull; Displacement: 8 tonnes</p><p><strong>MECHANICAL</strong>
- &bull; Engine: Volvo MD22L (1999)
- &bull; Horsepower: 50 HP
- &bull; Drive Type: Saildrive
- &bull; Fuel Type: Diesel
- &bull; Cooling: Fresh water
- &bull; Propeller: Max prop + spare
- &bull; Rope Cutter: Stripper
- &bull; Last Engine Service: Ongoing, constant maintenance</p><p><strong>PERFORMANCE</strong>
- &bull; Cruising Speed: 6 knots @ 2000 RPM
- &bull; Max Speed: 7 knots @ 2400 RPM</p><p><strong>TANKAGE</strong>
- &bull; Fuel: 220 litres (stainless steel)
- &bull; Water: 2 x 200 litres (plastic)
- &bull; Holding Tank: 50 litres (stainless steel)</p><p><strong>ELECTRICAL</strong>
- &bull; Domestic Batteries: 4 x 120Ah (1 year old)
- &bull; Starter Battery: 125Ah (6 months old)
- &bull; Alternator: 60A
- &bull; Inverter: Small inverter
- &bull; Solar: 4 x Solbian panels (480W total) (2016)
- &bull; Shore Power
- &bull; Battery Charger: 48A</p><p><strong>RIGGING</strong>
- &bull; Rig Type: Sloop
- &bull; Mast/Spars: Selden aluminium
- &bull; Mainsail Reefing: In-mast
- &bull; Furling Headsail</p><p><strong>SAILS</strong>
- &bull; Main (2007) &ndash; Good
- &bull; Genoa (2007) &ndash;&nbsp;<span>Serviceable</span>
- &bull; Storm Sail (2008) &ndash; Unused
- &bull; Cruising Chute &ndash; Good condition</p></strong>





# BAVARIA 38 Ocean

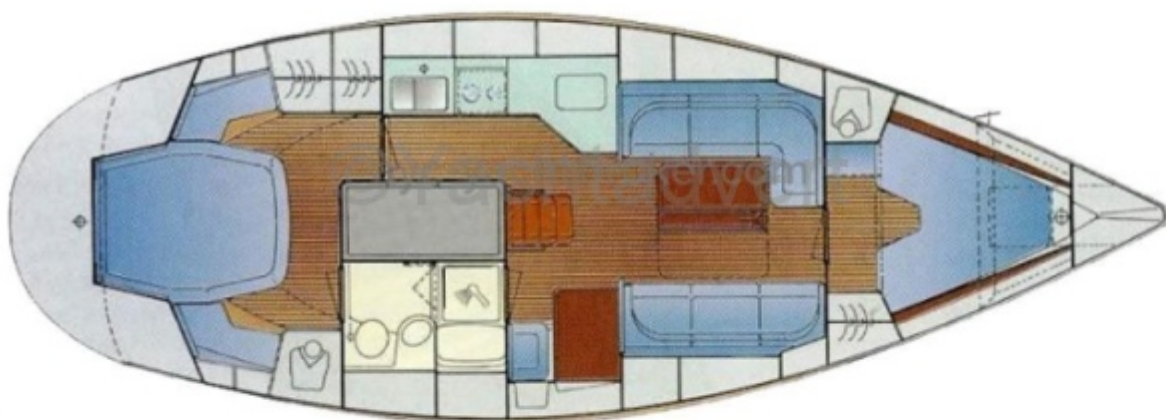

Center cockpit version/ Version cockpit central



# BAVARIA 38 Ocean

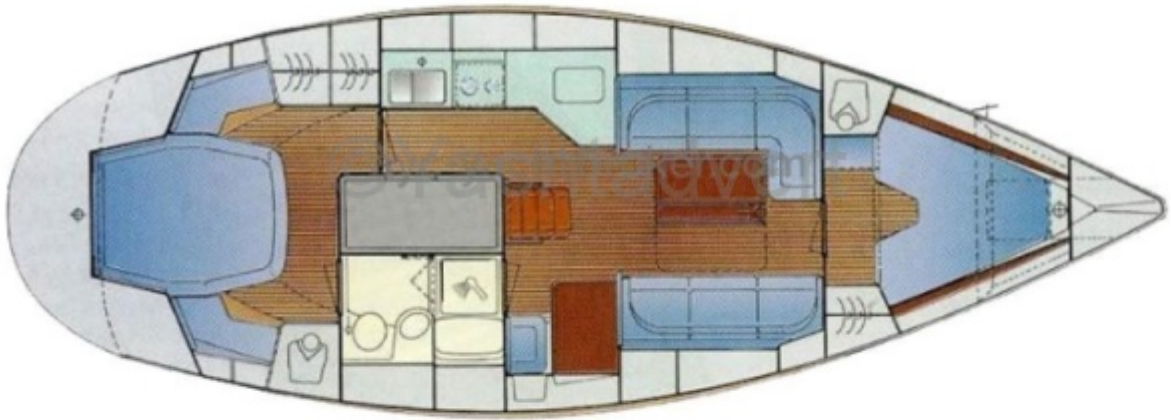

Center cockpit version/ Version cockpit central



# BAVARIA 38 Ocean

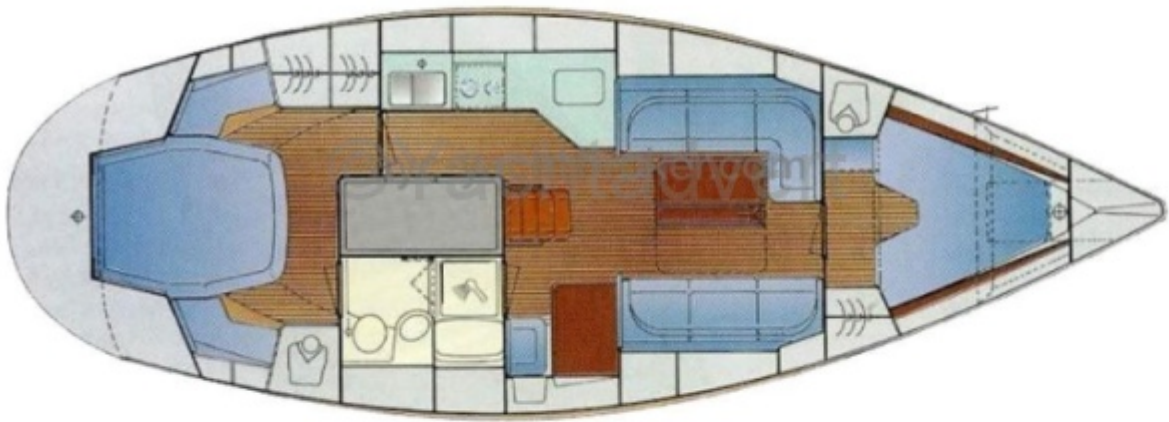

Center cockpit version/ Version cockpit central































































