



11 - 2021

<https://www.yachtadvert.com/2840-excess-11.html>

335 000 EUR incl vat



General

Year : 2021

Beam : 22.00 Ft

Life Raft : No

Leasing in progress : No

Builder : Excess

Length : 38.00 Ft

Draft : 0.00 Ft

Area : Lefkada, Greece

Engines

Facilities

Flybridge : No

Helm : No

Electronics

Autopilot : No

GPS : No

VHF : No

Watermaker : No

Radar : No

Sounder : No

Chartplotter : No

Converter 12/220 : No

Bridge equipment

Hydraulic Gangway : No

Bath platform : No

Winter cover : No

Sprayhood : No

Teak cockpit : No

Furling mainsail : No

Gangway : No

Davits : No

Electric windlass : No

Cockpit awning : No

Teak deck : No

Furling genoa : No

Spinnaker : No

Main equipment

Stern thruster : No

AC : No

Black Water : No

Tender : No

Bow Thruster : No

Marine Generator : No

Hot water : No

Flaps : No

Tender Engine : No

Household appliances

Freezer : No

Microwaves : No

Electric stove : No

Washing machine : No

TV antenna : No

SAT-TV : No

IceMaker : No

Oven : No

Gas stove : No

Heater : No

Dishwasher : No

TV : No

Various

Remarks :

DESCRIPTION

2021 Excess 11 sailing yacht, currently lying in Lefkas Marina and presented in a well-equipped, ready-to-use condition. This modern catamaran combines sporty sailing performance with a practical, easy-to-manage layout, making it an excellent option for relaxed island hopping with family and friends.

The yacht offers a versatile accommodation arrangement with four double guest cabins, two additional single berths in the bow compartments, and a convertible saloon, comfortably sleeping up to ten. The cockpit and helm areas are well designed for sociable time on board, featuring twin helm stations, full exterior cushions, biminis, and a spacious aft seating area with excellent storage.

Powered by twin Yanmar 29HP engines, both recently serviced in December 2025 along with the sail drives, she benefits from a reliable and efficient setup. The sail plan includes a square top mainsail and self-tacking jib, making her straightforward to handle whether short-handed or with guests on board.

A strong specification includes Raymarine navigation electronics, solar panels with Victron charging, AGM battery bank, electric toilets, hot water system, and a full inventory of cruising equipment. Supplied with a 2.90m RIB tender (2025) and Honda outboard, she is fully equipped for immediate use.

Highlights:

- 2021 Excess 11

- Located in Lefkas Marina

- 4 cabins plus 2 bow berths

- Sleeps up to 10

- Twin Yanmar engines (serviced December 2025)

- Sail drives serviced (December 2025)

- Square top mainsail and self-tacking jib

- Raymarine navigation suite

- Solar panels with Victron system

- Electric toilets and hot water

- Full exterior cushions and cockpit setup

- 2.90m RIB tender (2025) with Honda outboard

- Ready for immediate cruising

BROKER'S REMARKS

This Excess 11 offers a very appealing balance of modern styling, enjoyable sailing performance, and practical day-to-day usability. The twin helm arrangement keeps the cockpit open and social, while still giving the helmsman good visibility and control, making her particularly well suited to relaxed cruising with family and friends.

The layout is one of her strongest points, with four comfortable double cabins, additional bow berths for flexibility, and a bright, open saloon. On deck, the generous seating areas, full cushion package, and well-protected helm stations create an easy, sociable environment whether at anchor or underway.

Accommodation :

CONSTRUCTION

- Builder: Excess Catamarans

- Model: Excess 11

- Year: 2021

- Hull type: Catamaran

- Hull material: GRP

- • Deck and superstructure: GRP
- • Steering: Twin helm stations
- • Colour scheme: Light hull with graphite exterior upholstery
- • Flag: Greek

DIMENSIONS

- • LOA: 11.42m (37ft 6in)
- • Beam: 6.59m (21ft 7in)
- • Draft: 1.15m (3ft 9in)

MECHANICAL

- • Engines: 2 x Yanmar 29HP (3YM30AE)
- • Engine service: Yanmar serviced (December 2025)
- • Sail drives: SD25
- • Sail drives serviced and oil change (December 2025)
- • Propellers: 3-blade fixed (16 x 13)

Steering: Twin helm with leather covered wheels

PERFORMANCE

- • Cruising speed: Approx. 6 knots

Engine consumption: Approx. 8L/hour

TANKAGE

- • Fuel capacity: 440L
- • Fresh water capacity: 600L

ELECTRICAL

- • Solar panels with Victron smart charging system
- • Charge controller: Victron BlueSolar MPPT 75/15
- • Batteries: AGM
- • Service batteries: 4 x 140Ah
- • Engine batteries: 2 x 140Ah
- • Shore power: 32A
- • 220V sockets throughout
- • USB sockets in cabins, saloon and cockpit

SAILS

- • Full batten square top mainsail (Dacron) with lazy bag (Graphite)
- • Self-tacking jib (Dacron with UV strip)
- • Mainsail area: Approx. 55m²

Jib area: Approx. 22m²

NAVIGATION

- • Raymarine Axiom 7" display
- • Raymarine i70s displays
- • Raymarine p70 autopilot control
- • Raymarine autopilot system
- • Raymarine Ray90 VHF
- • GPS plotter
- • Depth sounder
- • Speed log
- • Wind system

DECK

- • Navigation tools and chart package
- • Electric windlass (Quick 1000W)
- • Anchor 20kg
- • 75m chain
- • 20m warp
- • Spare anchor and chain
- • Stainless steel davits
- • Stainless steel biminis (port and starboard helm)
- • Cockpit table (GRP)
- • L-shaped cockpit seating
- • Aft beam seating with large storage locker

- • Full exterior cushion set (Graphite)
- • Forward sunbathing cushions
- • Aft cockpit cushions
- • Stern sunshade tent
- • Deck lighting and indirect interior lighting
- • Cockpit shower (hot and cold)
- • Swim ladder (stainless steel)
- • Gangway (wooden)
- • Mooring kit (lines and fenders with covers)
- • Boat hook, hoses, winch handles and deck equipment
- • EPIRB
- • Lifteraft (10 person)
- • Lifejackets (adult and child)
- • Fire extinguishers
- • Distress flares and signalling equipment
- • Horseshoe lifebuoy
- • Floating light and fog horn
- • Radar reflector
- • Safety harnesses
- • Emergency tiller
- • Wire cutters and safety equipment
- • 4 double guest cabins
- • 2 bow single cabins
- • 2 heads with separate showers
- • 1 additional bow head
- • Saloon convertible to double berth
- • Sleeps up to 10

LAYOUT

The yacht features a practical and well-balanced layout with four double cabins arranged across both hulls, each pair sharing a head with separate shower. The addition of two bow cabins provides flexibility for occasional guests or storage, while the convertible saloon offers extra sleeping space when required. The saloon is bright and open, flowing directly into the cockpit for easy indoor-outdoor living.

TENDER

- • 2.90m RIB tender (2025)
- • Honda 5HP 4-stroke outboard

MISCELLANEOUS

- • Fusion audio system (saloon and cockpit)
- • Snorkelling equipment
- • Binoculars
- • Tool kit and spare parts
- • Sail repair kit
- • Cleaning equipment
- • Boat manuals

Inventory :

Mechanical :





















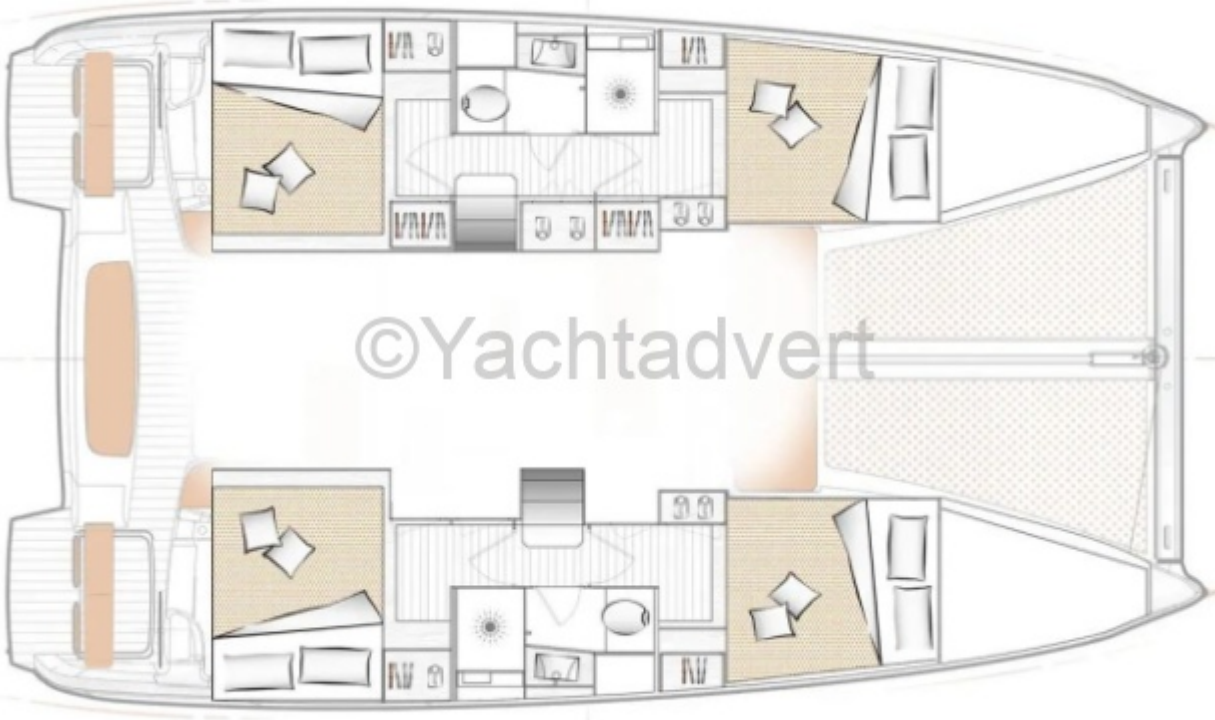

©Yachtadvert