



BENETEAU SENSE 55 - 2012

<https://www.yachtadvert.com/334-beneteau-beneteau-sense-55.html>

350 000 EUR incl vat



General

Year : 2012
Beam : 16.31 Ft
Life Raft : Yes
Leasing in progress : No

Builder : Beneteau
Length : 56.43 Ft
Hull : Monohull
Area : Alpes-Maritimes, France
Flag : français (France)

Engines

Model : 5LX
Power Unit. (HP) : 75
Shaft : Saildrive

Engine Brand : YANMAR
Engine(s) : 1
Hours : 3600
Tank : 415 L

Facilities

Head : 3
Berth : 7
Flybridge : No

Double Cabin : 3
WC : Sailor
Helm : No

Electronics

Autopilot : Yes
GPS : Yes
VHF : Yes
Watermaker : Yes

Radar : No
Sounder : Yes
Chartplotter : No
Converter 12/220 : No

Bridge equipment

Hydrolic Gangway : No
Bath platform : No
Winter cover : No
Sprayhood : Yes
Teak cockpit : Yes
Furling mainsail : No

Gangway : Yes
Davits : No
Electric windlass : Yes
Cockpit awning : Yes
Teak deck : Yes
Furling genoa : No
Spinnaker : No

Main equipment

Stern thruster : No
AC : Yes
Black Water : No
Tender : No

Bow Thruster : Yes
Marine Generator : No
Hot water : No
Flaps : No
Tender Engine : No

Household appliances

Freezer : No	IceMaker : No
Microwaves : No	Oven : Yes
Electric stove : No	Gas stove : No
Washing machine : Yes	Heater : No
TV antenna : No	Dishwasher : Yes
SAT-TV : Yes	TV : Yes

Various

XBOAT ref :5885.

Introduction to the Beneteau Sense 55

I am proud to present my **Beneteau Sense 55**, an exceptional sailboat built in **2012**. This boat perfectly embodies the values of the Beneteau shipyard: **Generous**, **Serene**, **Charming**, **Seaworthy**, and **Refined**.

Generous

The **Beneteau Sense 55** is designed to share wonderful moments without restraint. The serenity on board fosters friendship and happiness. The **exteriors** and **interiors** are offered in a design, dimensions, and materials that enchant life at sea. With a **length of 56.43 feet** and a **beam of 16.31 feet**, this sailboat offers exceptional living space.

Serene

Reconnect with inner peace in absolute intimacy. The **Beneteau Sense 55** is a well-being sailboat. Organized from stern to bow, its three living spaces allow for a perfect balance of intimacy and shared pleasure. This boat is equipped with **three double cabins** and **three heads**, offering optimal comfort for long voyages.

Charming

Experience the pride of fine things. Both sober and sleek, the **Beneteau Sense 55** provides intense satisfaction to the eye. Pleasure of contemplating the object, pleasure of the panoramic sea view. The **elegant design** and **high-quality materials** make this sailboat a true gem.

Seaworthy

Sail with confidence. The **Beneteau Sense 55** is a stiff and swift boat. Its hull heels little, and its perfect balance under sail are guarantees of surprising speed in unmatched sailing comfort. The grouping of all maneuvers at the helm provides considerable ease for sailing with a reduced crew. This sailboat is equipped with a **Yanmar engine** with a pivoting Sail Drive transmission and a Dock & Go system with joystick, greatly facilitating maneuvers.

Refined

Elevate elegance to an art of living. Spacious and flooded with light, the interiors of the **Beneteau Sense 55** belong to the world of SuperYachts. The **owner's cabin** offers exceptional amenities: **shower room**, **private office**, **numerous and functional storage**, **spacious and clear floor space**. Guests are welcomed in two double cabins arranged like private suites. This sailboat is also equipped with a **bow thruster**, a **generator**, and **air conditioning** for optimal comfort.

Equipment and Electronics

- Radar**
- VHF**
- Depth sounder**
- GPS**
- Chartplotter**
- Autopilot**
- Water maker**

The **Beneteau Sense 55** is also equipped with a **dinghy** with an **engine**, an **electric windlass**, a **cockpit bimini**, a **roof cover**, and a **teak cockpit**. The sails include a **furling genoa**, a

furling mainsail, and a **spinnaker**.

Why the Beneteau Sense 55 is interesting to buy?

The **Beneteau Sense 55** is an exceptional sailboat that combines elegance, performance, and comfort. Its generous design and high-end equipment make it an ideal boat for long sea voyages. Whether you are looking for a sailboat for family or friends cruises, the **Beneteau Sense 55** will meet all your expectations. Its Yanmar engine with pivoting Sail Drive transmission and Dock & Go system with joystick make it easy to maneuver, even with a reduced crew. Additionally, its three double cabins and three heads offer optimal comfort for all passengers. Finally, its numerous electronic and deck equipment make it a safe and pleasant sailboat to navigate.

More details and pictures on xboat.uk























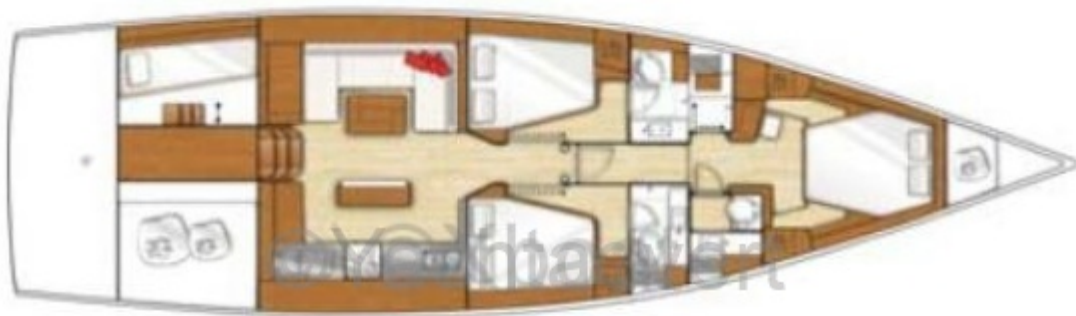

3 cabins + optional occasional berth • 3 cabines + couchage d'appoint optionnel •
 3 camarotes + litera adicional opcional • 3 cabine + cuccetta supplementare in opzione •
 3 Kabinen + Zusatzkoje (Extra)







